

emma's

P R O P E R T I E S



7 Cardiff Grove, Birmingham, B37 5EY
£1,200 Per month



Ground Floor
Approx. 33.0 sq. metres (355.4 sq. feet)

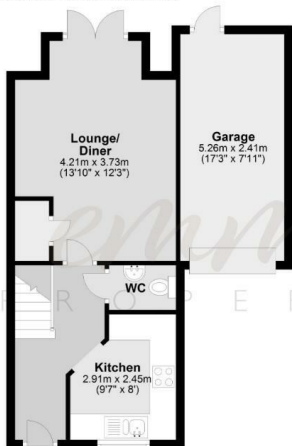

First Floor
Approx. 31.1 sq. metres (334.7 sq. feet)

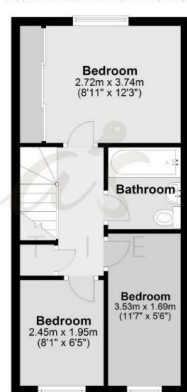

Total area: approx. 64.1 sq. metres (690.2 sq. feet)

Energy Efficiency Rating

	Current	Potential
Very energy efficient - lower running costs		
(92 plus) A		92
(81-91) B		
(69-80) C	76	
(55-68) D		
(39-54) E		
(21-38) F		
(1-20) G		
Not energy efficient - higher running costs		

England & Wales

EU Directive
2002/91/EC



emma's
P R O P E R T I E S

4 Rectory Lane, Rectory Lane, Birmingham, B36 9DH

Tel: 01217 944916

Email: Emma@emmasproperties.co.uk