

## Ground Floor

Approx. 45.3 sq. metres (488.1 sq. feet)

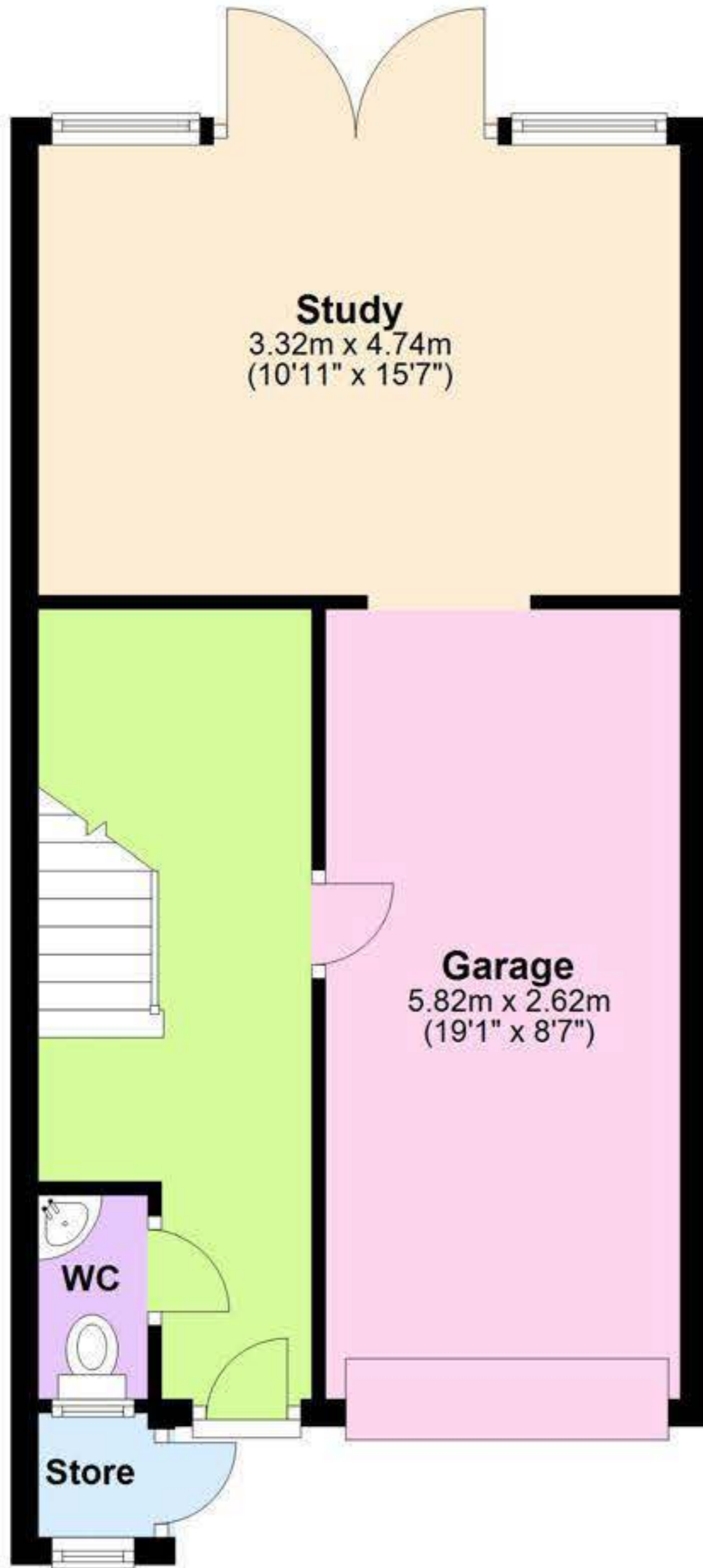

## First Floor

Approx. 44.5 sq. metres (479.1 sq. feet)

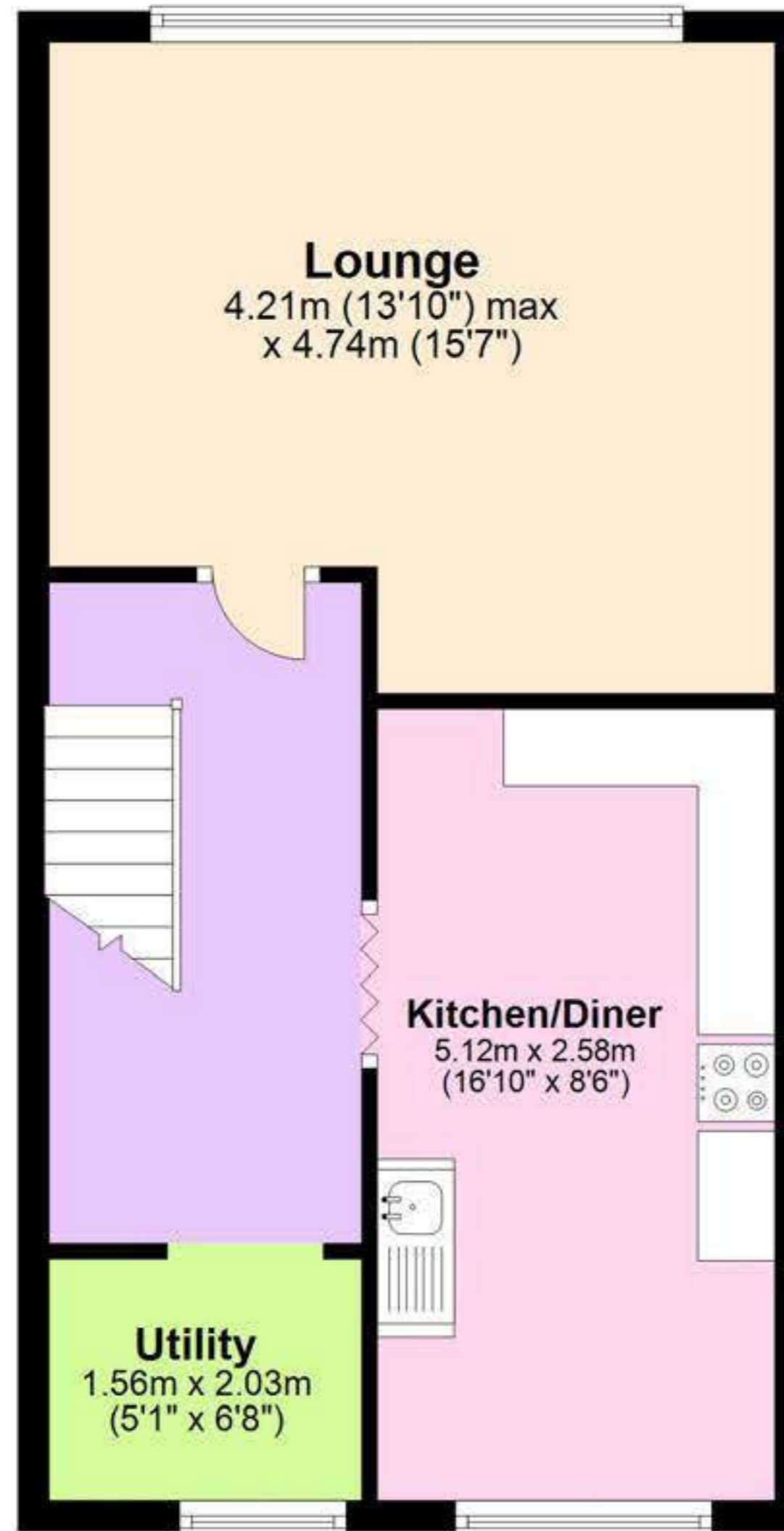

## Second Floor

Approx. 48.8 sq. metres (525.8 sq. feet)

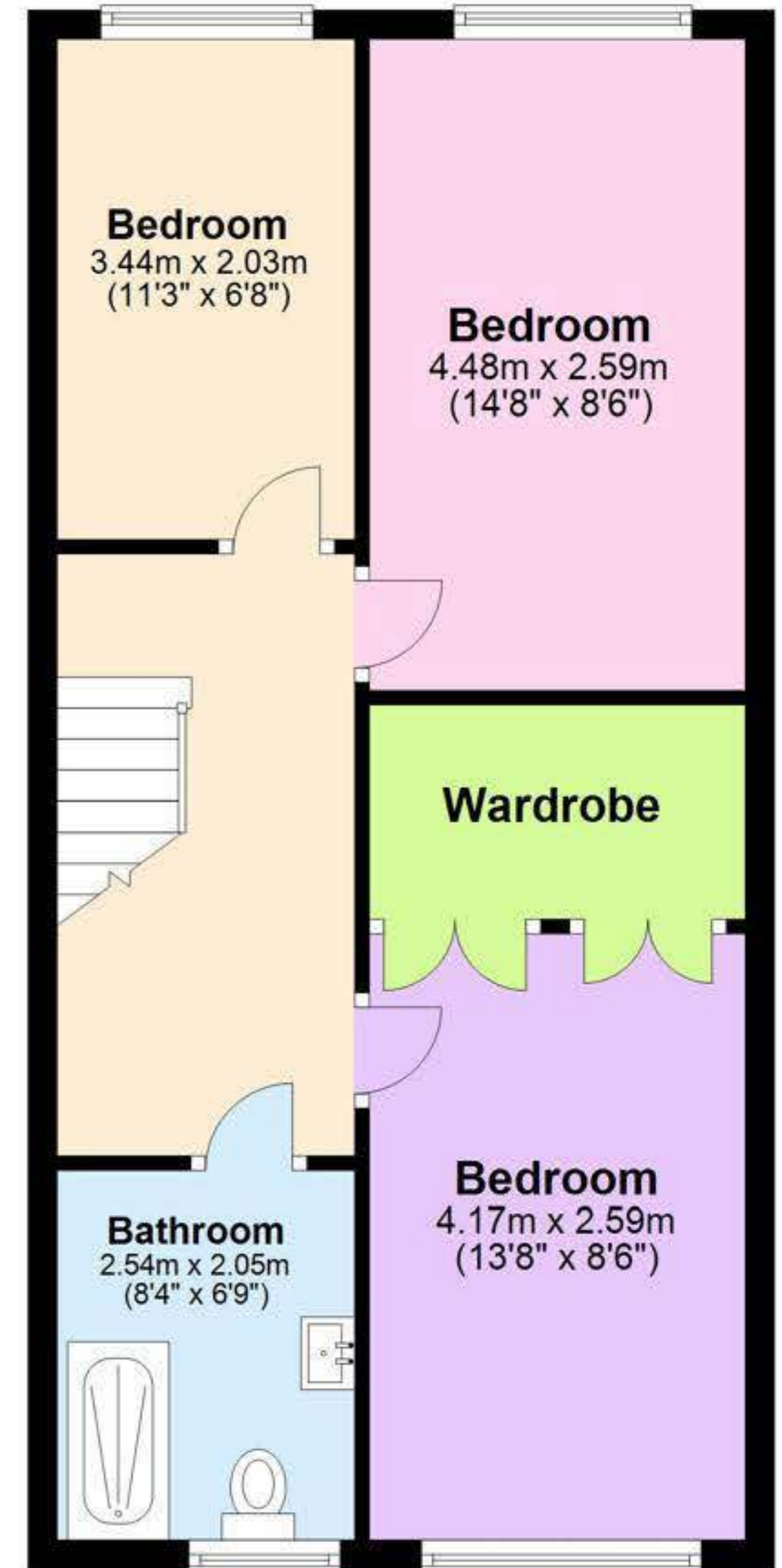

Total area: approx. 138.7 sq. metres (1493.0 sq. feet)